



## Guzzler® Hand Pump GH-M400D



- Flush-mounted below deck or behind wall
  - ◊ Max deck/wall thickness: 3/4 in
- Sleek, low-profile polypropylene cover plate available in black or white
- Removable, rugged aluminum handle
- Handle can be positioned in 12 different orientations relative to pump ports
- Accommodates 1/2" - 1-1/4" hose
- 10 GPM
- Ideal for use as bilge pump

### Specifications / Options

<b>Body &amp; Ports *</b>	Acetal (POM) Copolymer / Gray
<b>Clamp Ring</b>	Acetal (POM) Copolymer / Gray
<b>Handle</b>	Aluminum: Vertical (Removable)/ Silver
<b>Cover Plate (Trim Ring)</b>	Polypropylene (Black or White)
<b>Valves *</b>	Flapper, Duckbill, Umbrella
<b>Diaphragm *</b>	Buna-N, Buna-N Double Sided, Neoprene, Viton, EPDM, Silicone
<b>Clevis/Button Assembly *</b>	Acetal (POM) Copolymer / Gray
<b>Actuator</b>	Aluminum, Stainless steel

\* In contact with fluid

### Removable Handle and Cover Plate (Trim Ring) Options



Top view of closed Trim Ring and Removable Handle



Black Cover Plate



White Cover Plate

### Performance

<b>Flow Rate</b>	Per minute <sup>1</sup> : 10 Gal (37.9L) Per stroke: 0.44 Qt (0.42L)
<b>Max Lift</b>	12 ft (3.7 m) 22 ft (6.7 m) with check valve
<b>Max Head</b>	30 ft (9.1 m)
<b>Max Pressure</b>	15 psi (1.0 kg/cm <sup>2</sup> )
<b>Max Service Temp</b>	212°F (100°C)

<sup>1</sup>: at 90 cpm

### Available Ports

	in	1/2	3/4	1	1-1/8	1-1/4
	cm	1.27	1.91	2.54	2.86	3.18
<b>Hose (Smooth)</b>			•	S	•	•
<b>NPT Female (Tapped)</b>		•	•			
<b>NPT Male (Threaded)</b>			•	•		
<b>Male Garden Hose (Threaded)</b>			•			
<b>Barbed</b>			•		•	
<b>Female Garden Hose Adapter</b>			•			

S Standard • Optional

### Valve Options



**Flapper** — General purpose liquid transfer.



**Duckbill** — For dirty liquid and sewage. Permits mounting in any position.



**Umbrella** — Most efficient for pumping clean liquid. Also used for air and vacuum service.



Pump shown mounted to plexi-glass plate with white trim ring visible above mounting surface

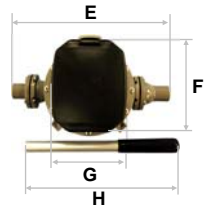
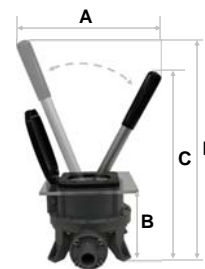

	in	cm
<b>A</b>	9-1/2	24.1
<b>B</b>	4-1/2	11.4
<b>C</b>	12	30.5
<b>D</b>	13-7/8	35.2
<b>E</b>	10-1/4	26.0
<b>F</b>	5	12.7
<b>G</b>	4-1/2	11.4
<b>H</b>	10-1/4	26.0
<b>J</b>	3-3/16	8.1
<b>K</b>	2-7/8	7.3
<b>Mounting Holes</b>	1/4	0.64
<b>Weight</b>	2.45 lb	1.11 kg

# Guzzler® Hand Pump GH-M400D



## Product Model Number Nomenclature Guide

**Example: GH-M400D-411-87-5050-00**

- Guzzler Hand Pump
- Model style #M400D: Acetal Body, Flush mount, Opposite Side Ports
- Removable Vertical Handle (Silver)
- Buna-N Flapper Valves
- Buna Diaphragm
- Stainless Steel Actuator
- White Polypropylene Cover Plate
- Inlet: 1" Smooth
- Outlet: 1" Smooth
- No Spring

Guzzler Product	
Option	Code
Hand Pump	GH

Style (Family)	
Option	Code
Acetal, Flush mount, Opp. Side Ports	M400D

Handle	
Option	Code
Vertical/Silver (Removable)	4

Valves	
Option	Code
Flapper (Buna-N)	1
Flapper (White Buna)	2
Flapper (Neoprene)	3
Flapper (Viton)	4
Flapper (EPDM)	5
Duckbill (Buna-N)	6
Umbrella (Silicone)	7

Diaphragm	
Option	Code
Buna Nitrile	1
Buna-N 3-Ply	2
Neoprene	3
Viton	4
EPDM	5
Silicone	7

**GH - M400D - 4 1 1 - 8 7 - 50 50 - 00**

Actuator	
Option	Code
Aluminum	7
Stainless Steel	8

Cover Plate	
Option	Code
Black	6
White	7

Hose Connections		
Option	Code	
	Inlet	Outlet
1/2" NPT Tapped	31	31
3/4" Smooth	40	40
3/4" NPT Tapped	41	41
3/4" NPT Threaded	42	42
3/4" Barbed	43	43
3/4" Female GH Adapter	45	45
3/4" Male Garden Hose	46	46
1" Smooth	50	50
1" NPT Threaded	52	52
1-1/8" Smooth	60	60
1-1/8" Barbed	63	63
1-1/4" Smooth	70	70

Internal Spring	
Option	Code
No Spring	00
Std Weight SS	10
Lightweight SS	20
Heavy Duty SS	30

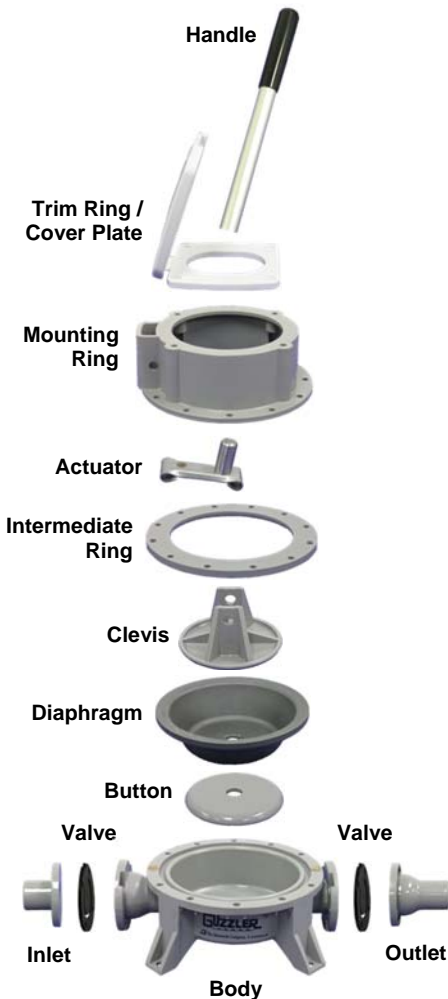

930 Waterman Avenue, East Providence, RI 02914  
 (401) 438-1110 • fax (401) 438-2713  
 toll-free (888) 438-1110 • www.thebosworthco.com