



*Reliable Products for a World of Industries*



MANUAL AND MOTORIZED DIAPHRAGM PUMPS  
*for*

**Water Transfer, Filtration and Purification**

---



*Did you find the Bosworth pumps in each of the cover photos?*

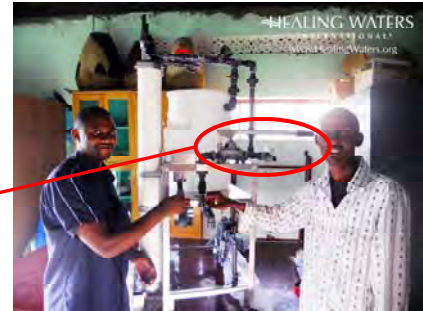
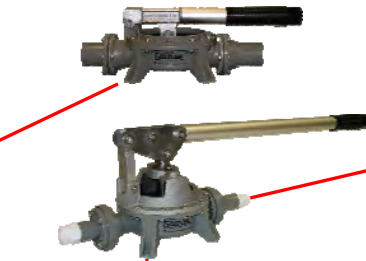

The Bosworth Company is the premier U.S. manufacturer of diaphragm hand pumps, foot pumps and motorized pumps. For over thirty years, Bosworth's Guzzler® line of diaphragm pumps has set the standard for quality and reliability. The Bosworth Company is ISO 9001:2008 certified in the design and manufacturing of pumps and valves, and a number of the Company's pump products also meet the CE standard for acceptance in the European market.

Bosworth hand pumps feature a simple design that offers rugged, lightweight plastic components for the pump body and flanges, coupled to a durable aluminum handle for pump activation. Bosworth pumps are long-lasting and easy to service in the field. Diaphragms are accessible and can be readily replaced for ease of maintenance.

Guzzler pumps can be operated at up to 15 psi of pressure, and have impressive lift/head capabilities. Without a check valve, a Guzzler hand pump can lift water 15 feet; with a check valve lifts as high as 22 feet have been achieved. The pump is available in components that are approved for potable water use.

Bosworth's top-of-the-line products serve industry needs in a wide range of markets, including marine, sanitation, industrial, OEM and water filtration. Bosworth Guzzler pumps are used as bilge pumps, dewatering pumps, sanitation pumps, grout pumps, glue pumps, priming pumps as well as in a host of other specialty applications. Bosworth products feature an extensive set of product options, creating literally millions of different product configurations to meet the requirements of diverse applications.

In addition to its standard product line, Bosworth also provides custom products to satisfy the needs of unique applications. Contact us to discuss how we can adapt our products to meet your requirements.

Cover photos courtesy of New Life International, Healing Waters International and CampWater Industries.

# Guzzler Diaphragm Pumps

*If you haven't got a Guzzler, you still need a pump!*

## BENEFITS

- **Economical** — capital costs to pump 25 liters of water (6.6 gals): less than \$ 0.01
- **Effective** — pump 25 liters of water (6.6 gals) in 2 minutes
- **Reliable** — dependable performance in demanding, “off-grid” environments
- **Versatile** — suitable for wide range of water transfer uses as well as pump-priming needs
- **Simple to deploy** — Attach hoses and start pumping; no instructions needed
- **Easy to operate** — light force on handle produces up to 15 psi
- **Easy to maintain** — easily replaceable diaphragm and valves for long life operation
  - \* No power tools required for maintenance



## FEATURES

- Maximum suction lift: 12 - 22\* feet
- Maximum pump head: 30 feet
- Self-priming
- Durable, lightweight plastic components
- Rugged aluminum handle
- Available with potable-water rated materials
- Replacement parts available for all pump components
  - \* with check valve

## ACTIVATION OPTIONS



Hand-operated



Extra long aluminum handle for ease of pumping.



Foot button



Foot Lever



Electric Motor

## MAINTENANCE

### Beauty in simplicity

*A Phillips Head Screwdriver — the only tool you'll ever need to maintain your Guzzler hand pump!*



*Maintain your Guzzler pump with easily replaceable, low-cost diaphragm and valve elastomer components for economical, long-lifetime operation.*



Pump diaphragms are available in a range of materials, including Buna-N, Viton, Neoprene, EPDM and silicone.

Pumps are available with three different valve styles to address a variety of fluid transfer or vacuum service needs.



Flapper



Duckbill



Umbrella



[www.thebosworthco.com](http://www.thebosworthco.com)

- View product features and options
- Select options to customize product for your application
- View product performance specs
- Access helpful information on product components
- Find replacement parts
- Download complete product specifications



Home > Products > Overview > Hand Pumps

Part Number Lookup:  Find

Home Industries Products Product Instructions News & Info How to Buy About Bosworth Login Downloads

**Guzzler® GH-0400D**

Replacement Parts Send Email Inquiry Store Locator

**Guzzler™ 400™**

Reliable, rugged, lightweight hand pump ideal for bilge or fluid transfer applications in marine or sanitation applications as well as for home or industrial uses.

- Durable, lightweight Delrin® plastic
- Accommodates 1/2" - 1-1/4" hose
- 10 GPM
- Rugged aluminum handle
- Clamp ring adjusts to 12 different handle orientations
- Available with either horizontal or vertical handle
- Optional aluminum clamp ring for added durability

FEATURE	OPTION
<a href="#">Edit</a> Handle Style	Horizontal/Silver
<a href="#">Edit</a> Valves	Flapper (Buna-N)
<a href="#">Edit</a> Diaphragm	Neoprene
<a href="#">Edit</a> Clevis/Button Assembly	Delrin Plastic
<a href="#">Edit</a> Clamp Ring	Delrin Plastic
<a href="#">Edit</a> Inlet Hose Connection	1" Smooth
<a href="#">Edit</a> Outlet Hose Connection	1" Smooth
<a href="#">Edit</a> Internal Spring	None
<a href="#">Edit</a> Pre-Pak Accessories	Not selected

[Additional Images](#)

Model #: GH-0400D-113-10-5050-00  
Order #:  Item ID:   
[MSRP](#) [Contact factory for pricing.](#)

**Performance**

Max Pressure	15 psi / 1.03 bar
Lift	12.0 ft / 3.7 m 22.0 ft / 6.7 m with check valve
Head	30 ft / 9.1 m
Capacity (@ 90 strokes/min)	10.0 gpm / 37.9 lpm
Volume per stroke	0.44 qt / 0.42 l
Max Service Temp	150° F / 66° C

**Accessories**

[Service Kit](#) [Hose](#) [Hose End Guff](#)

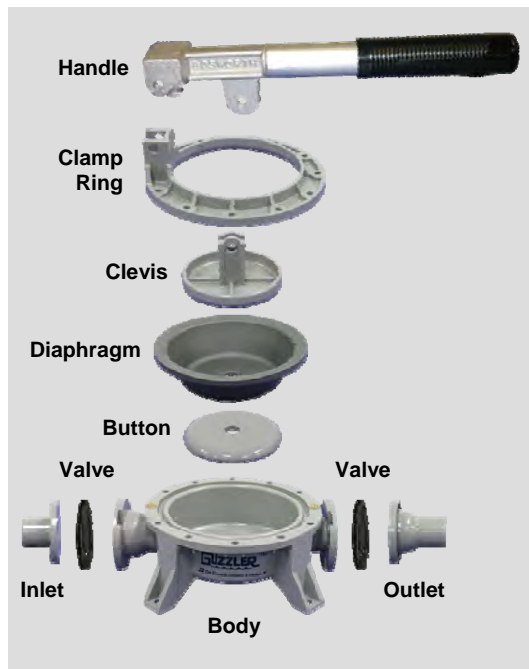

Exploded View of GH-0400D Guzzler hand pump

- Simple design
- Easy to maintain
- Replacement parts available for all pump components